

SEQ		BILL OF MATERIAL							
		SHIPPING MARK	ASSEM. MARK	NO. PCS.	DESCRIPTION	GRADE	LENGTH	MILL ORD.	REMARKS
1	1	1700B1		1	W18X50	A992	11'-5 1/16"		
	2		p1100	1	FL5/8"X7 1/2"	A572-50	10'-1 1/8"		
	3								
	4								
	5								
1	6	1700B2		1	W18X50	A992	12'-0 3/16"		
	7		p1103	1	FL5/8"X7 1/2"	A572-50	10'-6 3/16"		
	8								
	9								
	10								
1	11	1700B3		1	W18X50	A992	10'-8"		
	12		p1104	1	FL5/8"X7 1/2"	A572-50	9'-5"		
	13								
	14								
	15								
	16								
	17								
	18								
	19								
	20								
	21								
	22								
	23								
	24								
	25								
	26								
	27								
	28								
	29								
	30								
	31								
	32								
	33								
	34								
	35								
	36								
	37								
	38								
	39								
	40								

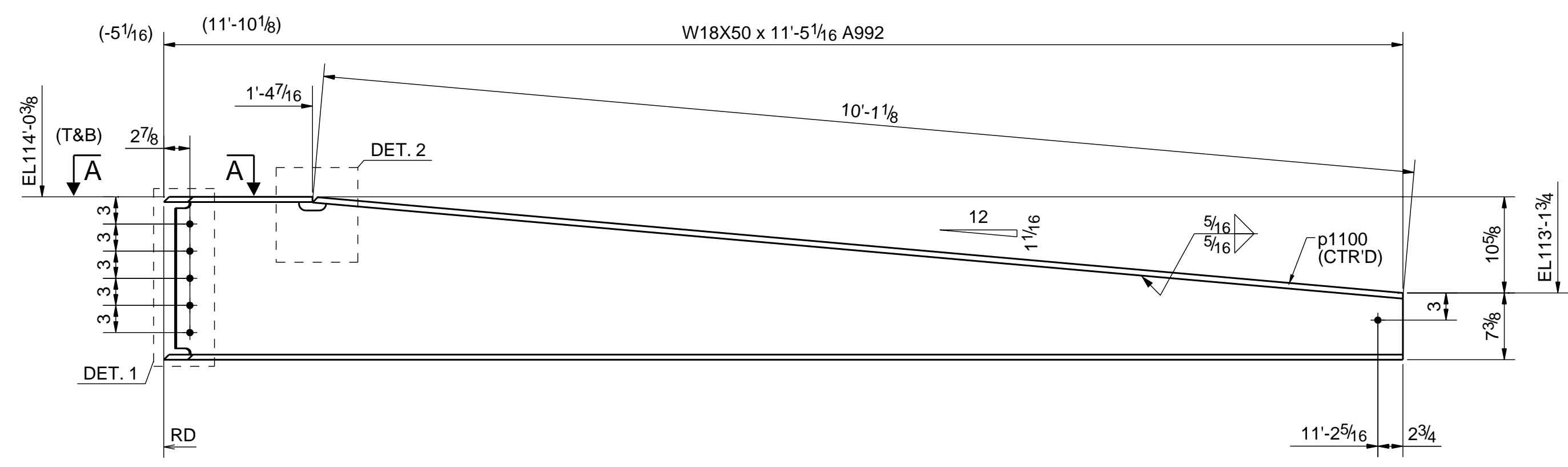

ONE - BEAM - 1700B1

W 18" x 3/8"
 F 7 1/2" x 9/16"
 K 0'-1 1/4"

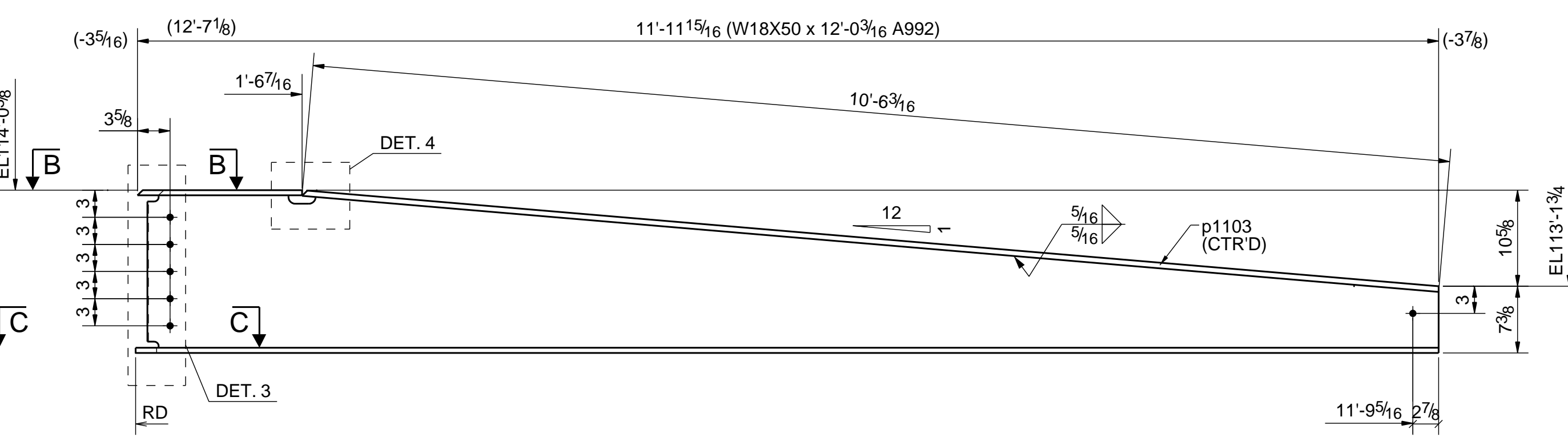

ONE - BEAM - 1700B2

W 18" x 3/8"
 F 7 1/2" x 9/16"
 K 0'-1 1/4"

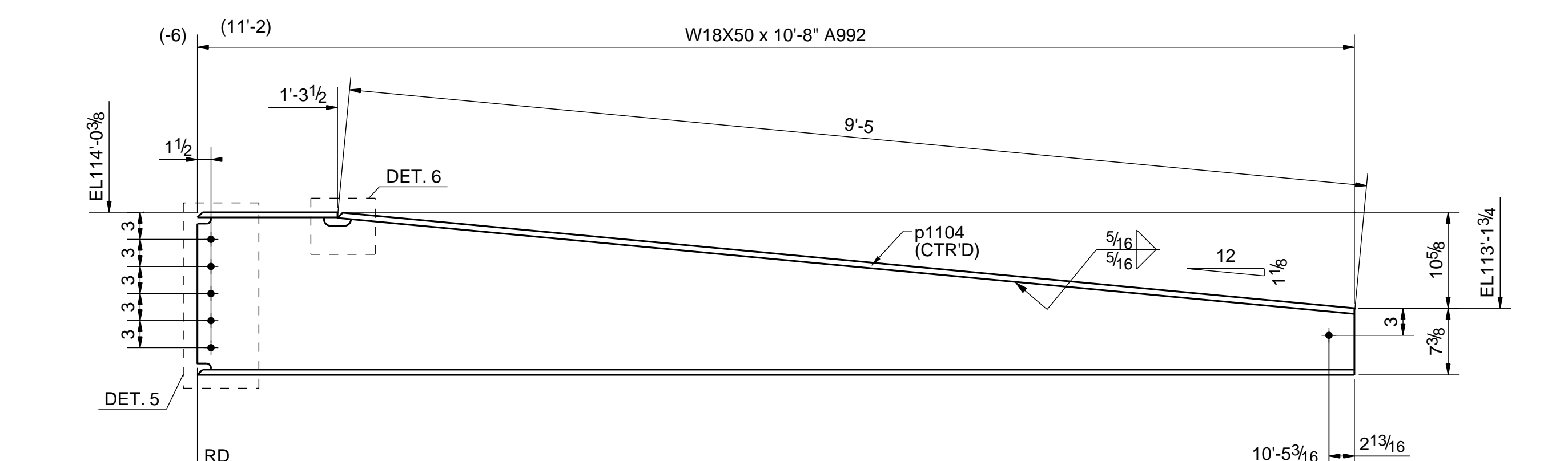

ONE - BEAM - 1700B3

W 18" x 3/8"
 F 7 1/2" x 9/16"
 K 0'-1 1/4"

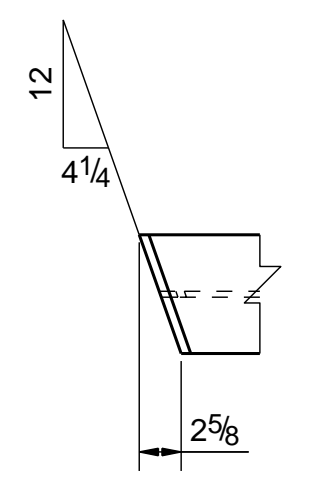

A - A

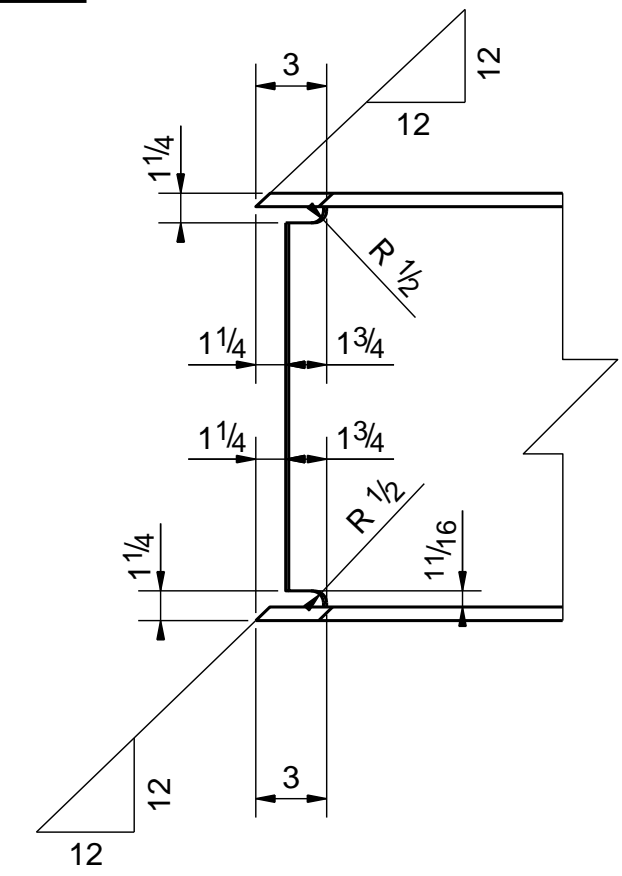

DETAIL 1

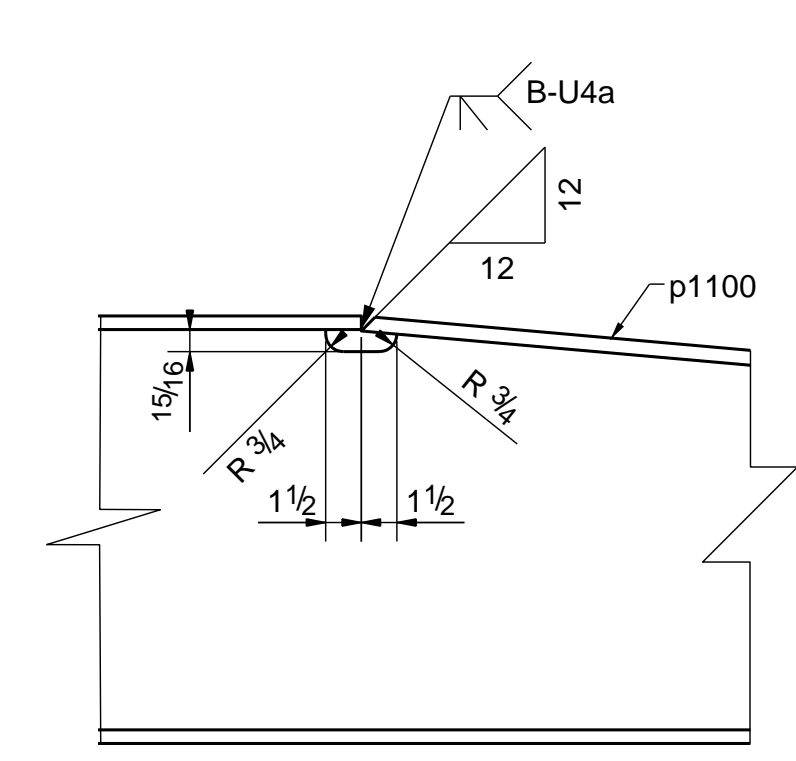

DETAIL 2

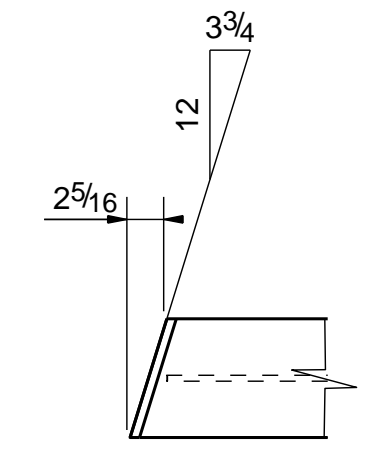

B - B

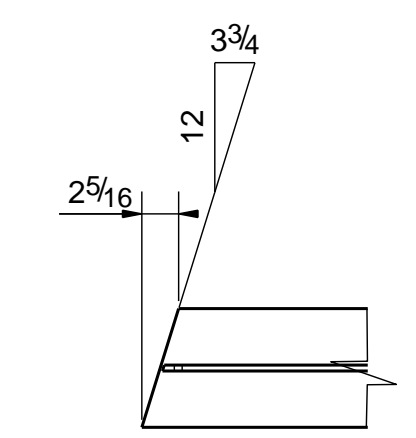

C - C

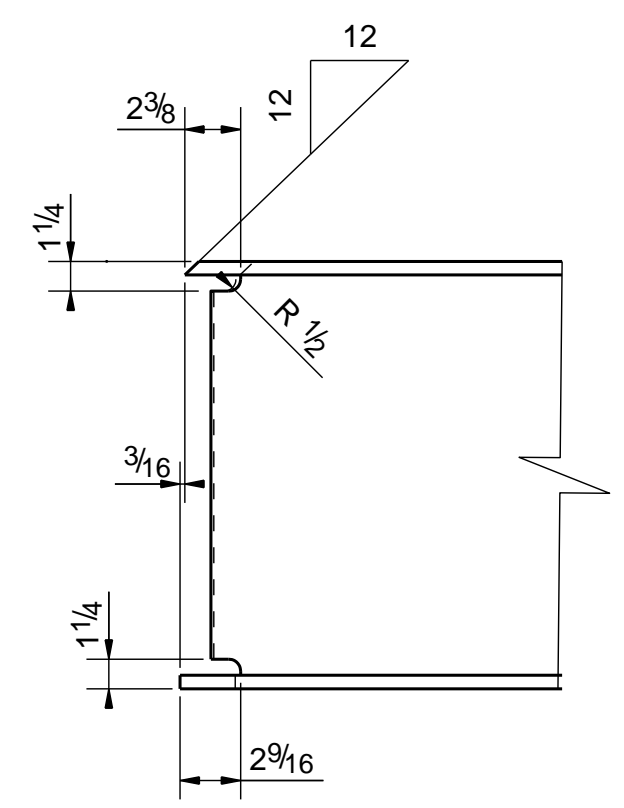

DETAIL 3

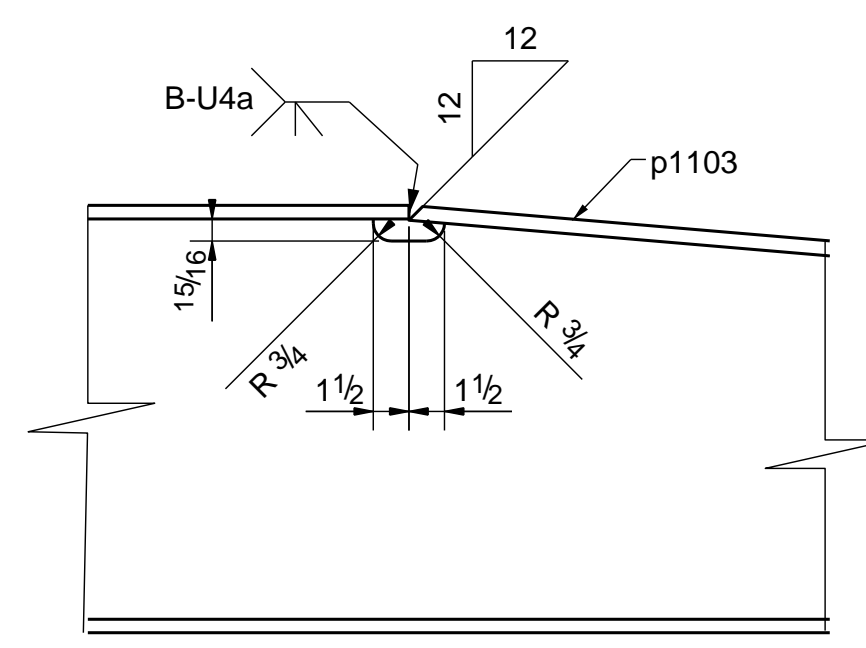

DETAIL 4

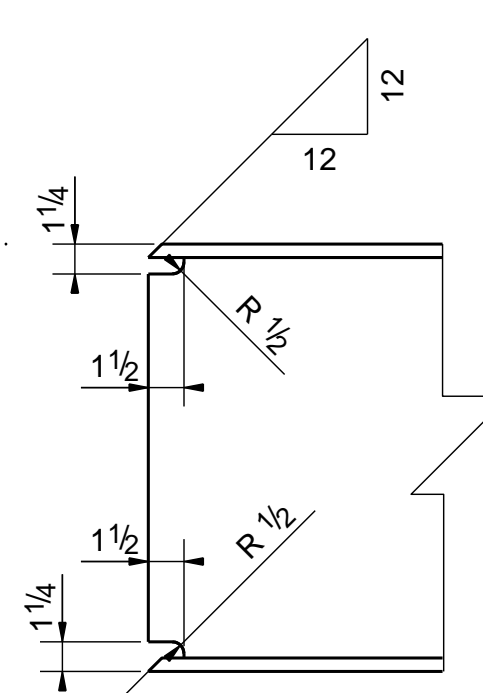

DETAIL 5

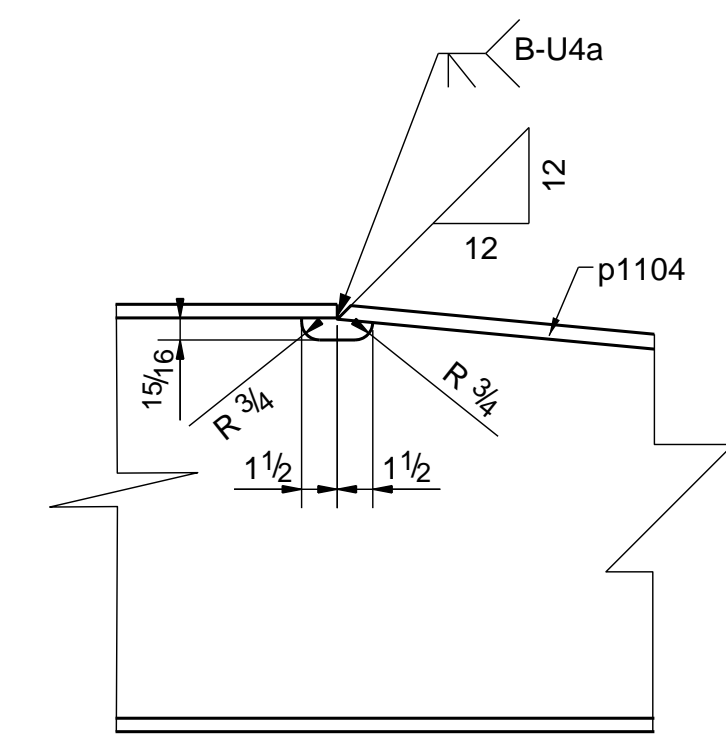

DETAIL 6

- ALL MATERIAL TO BE A36 UNLESS NOTED
- ALL TUBES TO BE A500-GRB (F_y=46) UNLESS NOTED
- ALL PIPES TO BE A53-GRB UNLESS NOTED
- ALL HS SHOP BOLTS TO BE TORQUED UNLESS NOTED
- ALL RUNNING DIMENSIONS FROM END OF MAIN MATERIAL
- ALL SHOP WELDS TO BE E70XX-LH ELECTRODES
- ALL COPES TO BE RADIUS
- ALL BEAMS TO BE FABRICATED WITH RESIDUAL CAMBER UP
- MEMBERS ARE TO BE ERRECTED SO THAT MARKED END IS IN SAME LOCATION AS ON ERECTION DRAWING

NO.	DIA.	LGT.	TYPE	F	LIW	F

REF. ERECTION DWG. NO. E1700



NO.	DATE	BY	REVISIONS
0	04/17/2015	S.S	FOR FABRICATION

NO.PTS.	DATE	USE	NO.PTS.	DATE	USE	NO.PTS.	DATE	USE

DRAWN BY: SR	CHECKED BY: NR	CONNECTIONS: 3/4ø A325N_TC	HOLE SIZE: 13/16ø U.N.	CLEANING: NONE	SHOP PAINT: NO PAINT
DATE: 02/10/2015	DATE: 12/04/2014	UNLESS NOTED	BOLT SIZE: 3/4ø U.N.	UNLESS NOTED	UNLESS NOTED

DWG. NO. 1700	ORDER NO. 332
---------------	---------------