

REV	DATE	DESCRIPTION
A	04/25/2015	For Approval

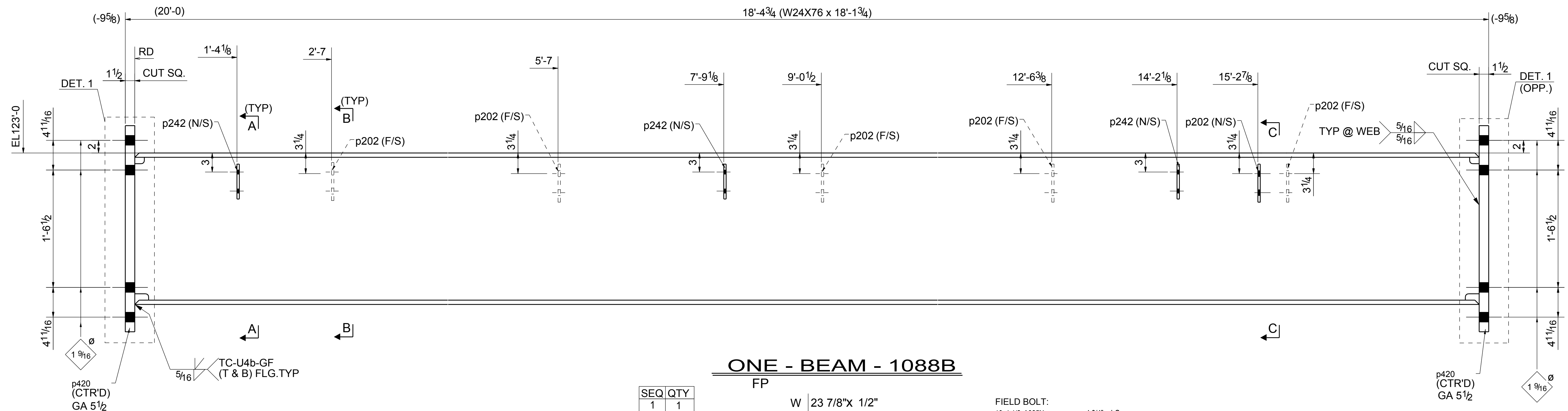
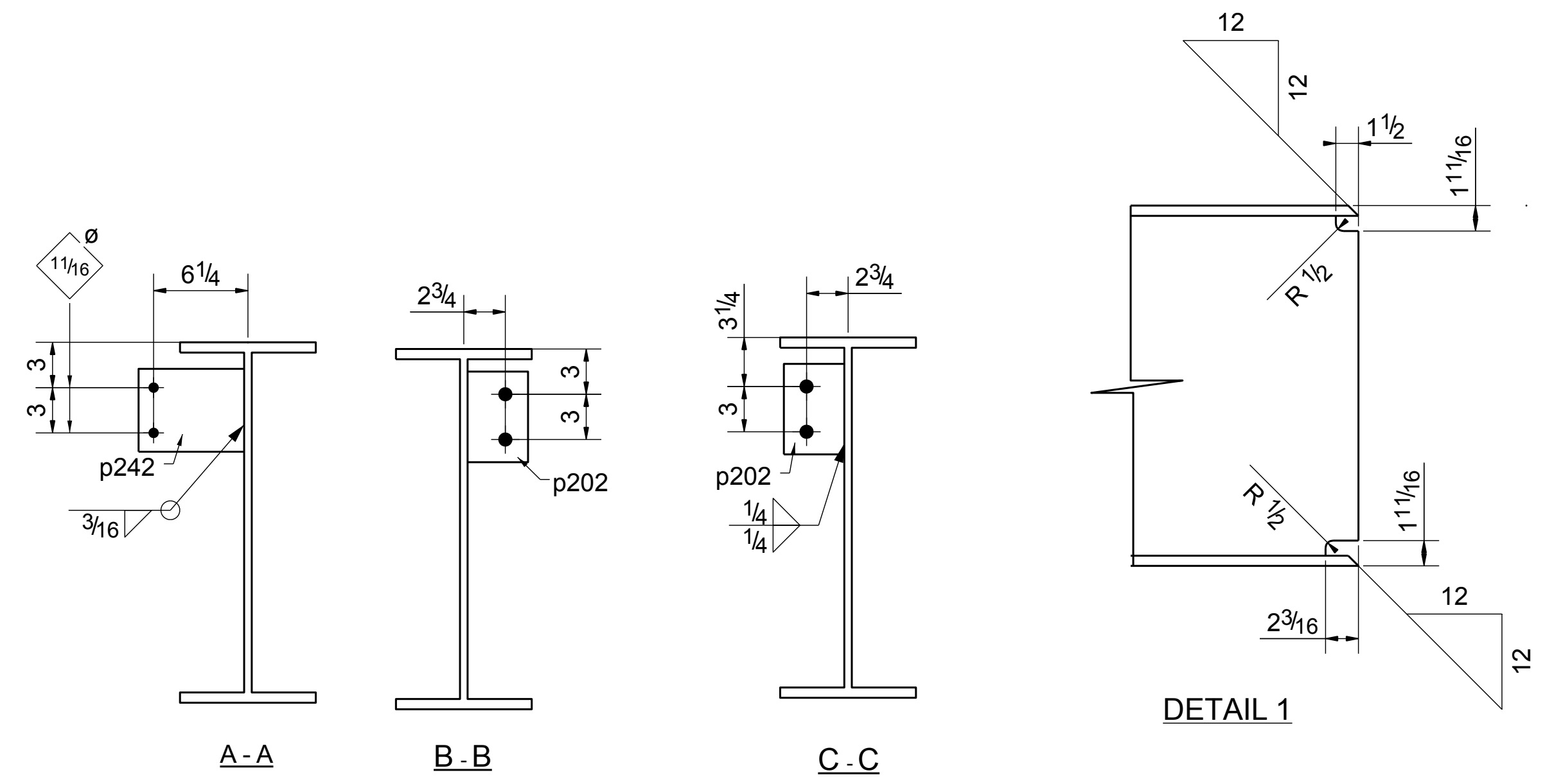

**ONE - BEAM - 1088B**  
 FP  
 W 23 7/8" X 1/2"  
 F 9" X 11/16"  
 K 1 9/16"

SEQ	QTY
1	1

FIELD BOLT:  
 16 1 1/2 A325N 4 3/4" LG

**COATING:**  
 SURFACE PREP: NONE  
 PRIMER: HOT DIP GALVANIZED

1. ALL STRUCTURAL W & WT SHAPES SHALL CONFORM TO ASTM A992. ALL OTHER MATERIAL SHALL CONFORM TO ASTM A36 (U.N.O.)
2. BOLTS TO BE HDG - 7/8" Dia. A325N WITH HD WASH (U.N.O.) 3. SHOP CONNECTIONS SHALL BE WELDED WITH E70XX ELECTRODES
4. WELDS: 1/4" FILLET (U.N.O.) 5. COLUMN TAILS ARE FROM TOP OF BASE PLATE 6. BEAM TAILS ARE FROM LEFT END OF MEMBER
7. OPEN HOLES: 15/16" Dia (U.N.O.) 8. ALL COLUMN BEARING AREAS TO BE WELDED
9. ALL CONTACT SURFACES TO BE SEALED WITH AN 3/8" CONTINUOUS FILLET WELD.

**BILL OF MATERIAL**

QTY	QTY	PIECE	MINOR	DESCRIPTION	LENGTH	REMARKS	WEIGHT	WEIGHT	STEEL	PAY
TOTAL	UNIT	MARK	MARK		FT.IN.		UNIT	TOTAL	GRADE	CODE
1	1	1088B		W24X76	18'-1 3/4"	S2E,P2E 2/23	1383	1687	A992	
6	6		p202	FL3/8"X4"	0'-6"		3	15	A572-GR.50	
3	3		p242	FL3/8"X5 1/2"	0'-7"		4	12	A572-GR.50	
2	2		p420	PL1 1/2"X10"	2'-8 1/2"		138	277	A572-GR.50	

**BILL OF MATERIAL**

QTY	QTY	PIECE	MINOR	DESCRIPTION	LENGTH	REMARKS	WEIGHT	WEIGHT	STEEL	PAY
TOTAL	UNIT	MARK	MARK		FT.IN.		UNIT	TOTAL	GRADE	CODE

**BILL OF MATERIAL**

QTY	QTY	PIECE	MINOR	DESCRIPTION	LENGTH	REMARKS	WEIGHT	WEIGHT	STEEL	PAY
TOTAL	UNIT	MARK	MARK		FT.IN.		UNIT	TOTAL	GRADE	CODE

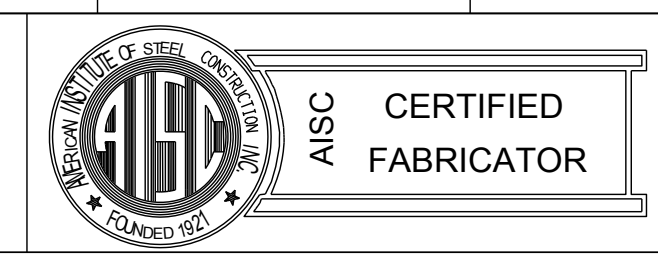

DRAWN BY	CHECKED BY	SEQUENCE NO:	REFERENCE DRAWING	DATE	JOB NO.	DWG. NO.
PK	SB	1506-1	E1002	04/25/2015	1506	1088